



BUCKINGHAMSHIRE  
NEW UNIVERSITY

EST. 1891



# COURSE WELCOME PACK



Welcome to Buckinghamshire New University!

We are looking forward to you joining **MSci (Hons) Cyber Security** in September.

In case you need a reminder or have missed anything, here are links to important information you will need before you join us:

[Enrolment](#)

[Accommodation](#)

[Digital and Technical Services](#)

[Bursaries and Scholarships](#)

[Disability and Inclusion Service](#)

[Bucks Students' Union](#)

[Our new student checklist can be found here.](#)

Looking for something in particular? Here are quick links to areas of this document:

[Welcome Week](#)

[About Your Course](#)

[Your Course Leader](#)

[Recommended Reading](#)

## YOUR WELCOME WEEK AT BNU

Your Welcome Week will run from **Monday 29<sup>th</sup> September to Friday 3<sup>rd</sup> October 2025** at our **High Wycombe Campus** and you will be provided with a full Welcome Week timetable in the coming weeks. All the information you need will be on the [Welcome Page](#) on our website so please check that regularly.

## ABOUT YOUR COURSE

This integrated master's degree is a full time, four-year undergraduate course, which combines undergraduate and postgraduate study levels (Level 4 – Level 7). This degree gives you the opportunity to explore your interest and learning in greater detail and obtain a master's degree at the end of your course.

This programme will equip you with state-of-the-art technical knowledge, intellectual know-how, management capabilities and practical skills that will enable you to successfully navigate through the cyber security challenges facing organisations today. You will develop a well-rounded appreciation of the issues facing our hyperconnected society and you'll explore the technological, legislative and social issues that impact organisations today. Alongside this, you'll meet and be taught by practitioners from industry who will provide insight into the current issues and how these are being addressed.

All modules have been designed with input from key industry governing bodies and experts such as the Communications-Electronics Security Group (CESG), a group within the UK Government Communications Headquarters (GCHQ), as well as Institute of Information Security Professionals (IISP) Information Security Skills Framework. When you graduate you will have strong technical skills and strong business acumen, making you well prepared to work in a range of industries in both public and private sectors, or to continue to develop your knowledge with further study.



You will enjoy opportunities to expand your knowledge both inside and outside of the lecture theatre. Students have previously visited sites of historical importance, including [Bletchley Park](#), to learn more about the history of computing and how it impacted the world.



We are proud to have a partnership with Amazon for running Amazon's AWS Academy at BNU, helping you gain industry standard knowledge and skills and further enhance your career prospects. This forms part of our undergraduate module Cloud Computing and allows you to have full access to all Amazon web services resources, materials, labs, online assessments and exam preparations.

You will be able to practice the technology provided by the world cloud leader, undertake a free Amazon AWS official certification MOC exam and gain a 50% discount on Amazon AWS (Cloud Architecture) official certification exam (*optional for students*). For further information, please contact [Dr Rafid Al-Khannak](#).

## **YOUR COURSE LEADER**

Your course leader is [Dr Rafid Al-Khannak](#) who can be contacted via [rafid.al-khannak@bnu.ac.uk](mailto:rafid.al-khannak@bnu.ac.uk).

## **YOUR RECOMMENDED READING**

Details of your full reading list will be made available to you when your teaching starts. There is no need to buy books before you join as all your recommended reading will be available through our [library](#). However, if you would like to do some reading before you join us we recommend selecting a book around one of the following subject areas to get you thinking about your course:

- Computer Architecture
- Networking (CISCO)
- Network Systems (CISCO)
- Python
- Cloud Computing

If you have any general questions before you start please contact [welcome@bnu.ac.uk](mailto:welcome@bnu.ac.uk), or for course specific questions please get in touch with me via [rafid.al-khannak@bnu.ac.uk](mailto:rafid.al-khannak@bnu.ac.uk).

We look forward to welcoming you soon!

[Dr Rafid Al-Khannak](#)

**Course Leader, MSci Cyber Security**

We will consider any request for accessible formats that may be required. Please send your request to [welcome@bnu.ac.uk](mailto:welcome@bnu.ac.uk).

# BNU Disability & Inclusion Transition Day

## WHEN

Wednesday 17th  
September 2025

MORNING SESSION: 09.00 - 12.30 OR

AFTERNOON SESSION: 13.00 – 16.30

## WHERE

High Wycombe Campus



QUEEN ALEXANDRA ROAD, HIGH WYCOMBE,  
BUCKINGHAMSHIRE, HP11 2JZ

## WHAT TO EXPECT:

-  Tailored Campus Tour - explore at your own pace.
-  Meet Our Support Teams - in a relaxed environment.
-  Starting Uni - helpful resources & information.
-  Q&A Space - ask anything on your mind, no pressure.
-  Optional Activities - relaxed, inclusive and fun.
-  Parent & Guardian Talk – key information just for them

## INTERESTED IN ATTENDING?

Please complete [this form](#) by 17.00 on September 10<sup>th</sup>.

 You're  
Invited! 

A SPACE  
JUST FOR  
YOU!

 We offer a free  
shuttle bus service  
from our Uxbridge  
campus to the High  
Wycombe campus:  
[https://www.bucksstud  
entsunion.org/union/tra  
nsport/campuslink/](https://www.bucksstudentsunion.org/union/transport/campuslink/)

**Any questions or  
concerns? Please  
get in touch:  
[inclusion@bnu.ac.uk](mailto:inclusion@bnu.ac.uk)**



# High Wycombe Campus



- Gateway Building (e.g. G.1.01)
- East Wing (e.g. E.1.01)
- Dove
- South Wing (e.g. S.1.01)
- North Wing (e.g. N.1.01)
- Timberlake (e.g. T.1.01)
- West Wing (e.g. WW.1.01)
- Red Shed
- Owen Harris (e.g. OH.1.01)

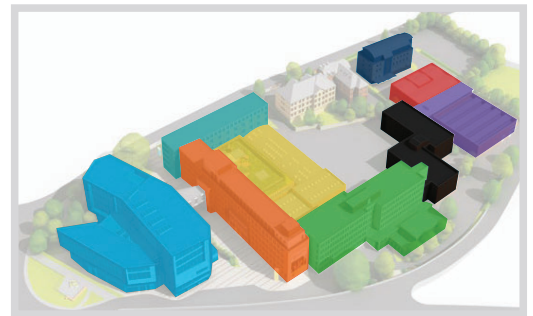

## Key locations on campus

### Gateway Building (e.g. G.1.01)

- + Security and First Aid Hub
- + School of Business and Law
- + School of Creative and Digital Industries
- + Dance Studio / Drame Studio
- + Events Hall
- + Garden Cafe
- + Gateway Gym
- + Gateway Lecture Theatre

### East Wing (e.g. E.1.01)

- + Main Reception Entrance
- + Apprenticeships Hub
- + Dance Studios

### Dove

- + School of Engineering and the Built Environment
- + A&E Simulation Centre
- + Atrium / Student Hub
- + Beeches Cafe
- + Radiography Lab
- + Roof Garden
- + Winter Garden

### South Wing (e.g. S.1.01)

- + School of Health and Social Care Professions
- + School of Human and Social Sciences
- + Health Hub
- + Running Track
- + Sports Clinic

### North Wing (e.g. N.1.01)

- + Students' Union
- + Accommodation Hub
- + Counselling Service
- + Teaching Rooms

### Timberlake (e.g. T.1.01)

- + Graphic Design Suites
- + Workshops

### West Wing (e.g. WW.1.01)

- + Dance Studios
- + Acting and Theatre
- + Teaching rooms

### Red Shed

- + School of Art, Design and Performance
- + Art Studios
- + Textile Studios

### Owen Harris (e.g. OH.1.01)

- + Lecture Theatres

**In you require further assistance please visit the main reception**

[bnu.ac.uk](http://bnu.ac.uk)



**BUCKINGHAMSHIRE  
NEW UNIVERSITY**  
EST. 1891



**High Wycombe Campus**

Queen Alexandra Road  
High Wycombe  
Buckinghamshire HP11 2JZ

**Aylesbury Campus**

Walton Street  
Aylesbury  
Buckinghamshire HP21 7QG

**Uxbridge Campus**

106 Oxford Road  
Uxbridge  
Middlesex UB8 1NA

**BNU based at  
Pinewood Studios**

Pinewood Studios  
Pinewood Road  
Iver Heath  
Buckinghamshire  
SL0 0NH

**Missenden Abbey**

London Road  
Great Missenden  
Buckinghamshire  
HP16 0BD

Telephone: 0330 123 2023  
Fax: 01494 524 392  
International: +44 1494 605 259  
Email: [advice@bnu.ac.uk](mailto:advice@bnu.ac.uk)



[BuckinghamshireNewUniversity](https://www.facebook.com/BuckinghamshireNewUniversity)



[@\\_BNUNi](https://www.instagram.com/_BNUNi)



[\\_BNUNi](https://www.youtube.com/_BNUNi)